

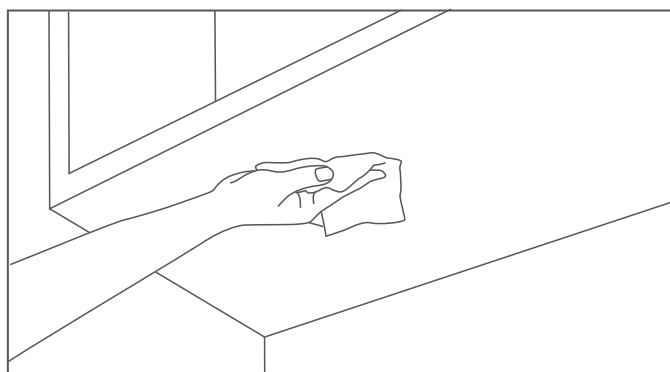

RollGrip™

How to mount:
(Screws included)



- ❶ Clean underside of shelf and dry completely.

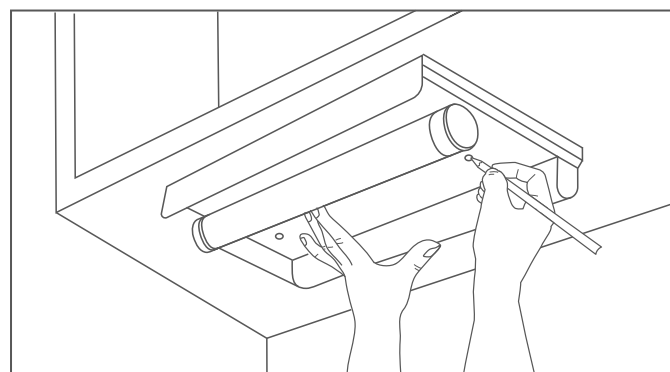

- ❷ Place kitchen roll holder in desired position and mark screw holes with a pencil.

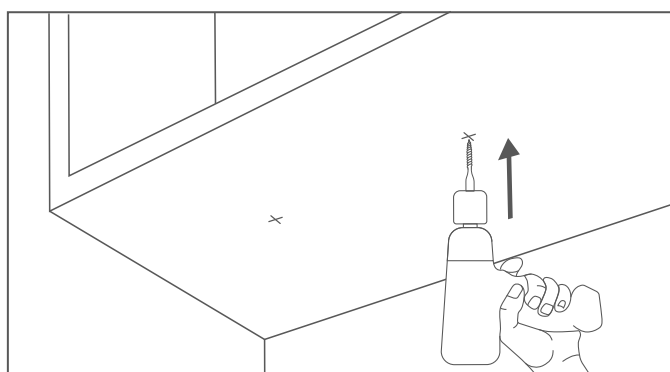

- ❸ Make a small hole at each pencil mark with a drill.

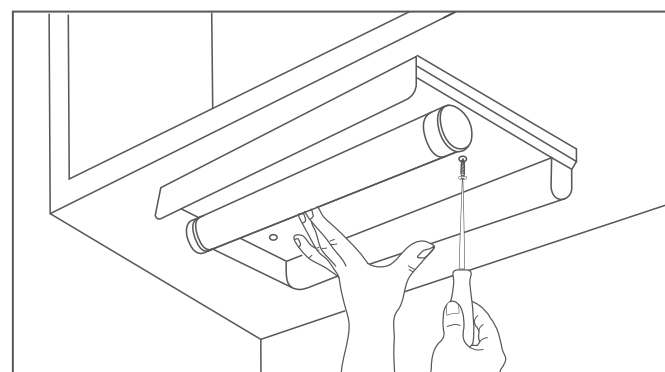

- ❹ Align kitchen roll holder to screw holes and fix into place using screws provided.



Joseph Joseph Ltd.
100 Union Street,
London SE1 0NL, United Kingdom.
www.josephjoseph.com